

# How to Use Your Rug Doctor Machine to Clean Carpets

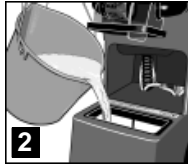

When cleaning an entire room, move furniture to the centre of the room. Begin cleaning where furniture was, then return furniture to its original location. Avoid staining carpet by placing plastic or aluminium foil under furniture legs. Clean remainder of carpet. When finished, leave plastic or aluminium foil under furniture legs until carpet is completely dry. Complete the following steps to clean your carpets.



## **Before You Begin**

Using a normal dry vacuum cleaner, sweep the area you want to clean to remove loose dirt before using the Rug Doctor machine. This helps keep the brushes and water vacuum system efficient. Pre-treat any special problem areas with the appropriate Rug Doctor solutions.

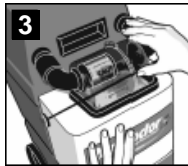

## **Set Up**

Depending on how dirty carpets are, mix 1/2 cup of Rug Doctor Carpet Cleaner product to 9 litres of hot tap water (not boiling) in a clean household bucket. Water should not be so hot as to scald or burn skin. The lower tank C capacity for the Rug Doctor Mighty Pro is 9 litres and for the Rug Doctor Wide Track is 14 litres. (ILLUS.1)



Lower the retaining wire A and remove the white UPPER tank B.



Fill the LOWER tank C with the cleaning solution you just mixed by pouring through the white filter screen. Machine is full when liquid halfway covers filter screen. (ILLUS.2)

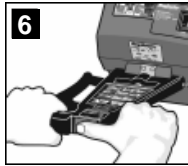

Slip tank back in place and seal tank and clear dome D securely by replacing retaining wire A (ILLUS.3).

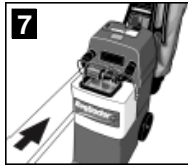

Check the back of the machine to ensure hose connections are secure and set up to clean carpet instead of upholstery. (ILLUS. 4)

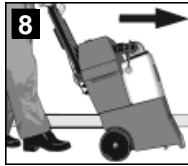

Plug in the power cord and position the machine. Refer to label on top of the machine E. Press the "ON" switch for CARPET cleaning on the top of the machine (ILLUS.5).

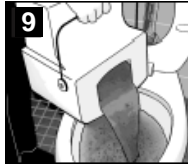

## **Start Cleaning**

While depressing the red button on the handle F (ILLUS.6), pull the machine slowly and steadily backward in a straight line, keeping vacuum slot G against the carpet surface. You will begin to see soiled solution entering the clear dome D. (If you don't, stop and refer to the [Troubleshooting](#) section.) **IMPORTANT:** When depressing the handle button, keep machine moving so the vibrating brush does not agitate in one place. (ILLUS.7)



Release the button 30 cm – 60 cms before ending each pass to stop cleaning solution. Tilt machine back and push it forward to position it for another backward cleaning pass (ILLUS.8). Continue cleaning in this manner, overlapping each pass slightly. When the lower tank runs out of cleaning solution, the pump sound will increase in volume slightly and dirty water will stop entering the dome. Switch the machine "OFF". Remove and empty the white UPPER tank B by pouring dirty solution into a toilet or outdoors (tank will be half full) (ILLUS.9). Rinse the upper tank and refill the LOWER tank C with clean solution/water mixture. If you are near the end of your cleaning job, fill the LOWER tank half full so it empties by the end of your job. Replace the upper tank B. Continue the cleaning process until area to be cleaned is covered. When cleaning is complete, empty any remaining solution by taking machine outside or over drain and turn machine ON for upholstery, this will empty lower tank.

## **Additional Resources:**

- [How To Clean Upholstery](#)